

# Load Sensing Control Valve KLSV18







## II. Safety Precautions

Before Puuf8 (5P) (5E) P



# IV. Conversion Factors and Definition

## ◆ Conversion Factors

$\rho$		
	1	1
	1 /	0.2
L	1	0.03
M	1 k	2.21
	1	0.3

## ◆ Definition

---



---



---



---



---



---



---



---



---



---







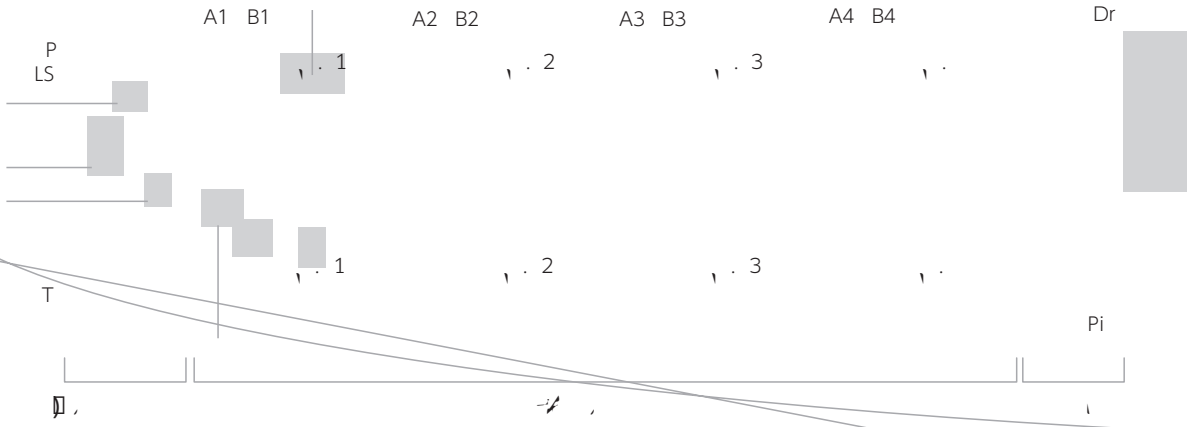

◆ Inlet section

- 1.
- 2.
- 3.

◆ Spool section

- 1.
- 2.
- 3.

◆ Other function

- 1.
- 2.
- 3.



✓ ✓ ✓ ✓ *				
Ø				

## 2. Inlet Section

### 2-2 Specifications

#### ◆ General specifications

Maximum pressure	MPa (psi)	P port	40 (5,800)
		LS port	40 (5,800)
		T port	1 (145)
Maximum flow	L/min (gallon/min)	P port	240 (63)

#### ◆ Main relief valve

Set pressure range	MPa (psi)	18~40 (2,470~5,800)
Maximum flow	L/min (gallon/min)	300 (79)

#### ◆ LS relief valve

Set pressure range	MPa (psi)	7~40 (1,020~5,800)
Maximum flow	L/min (gallon/min)	45 (12)

U-1 蛎崇 ヨ

#### ◆ Unloading valve

Cracking pressure	MPa (psi)	2.3~3.1 (334~450)
Maximum flow	L/min (gallon/min)	50 (13)

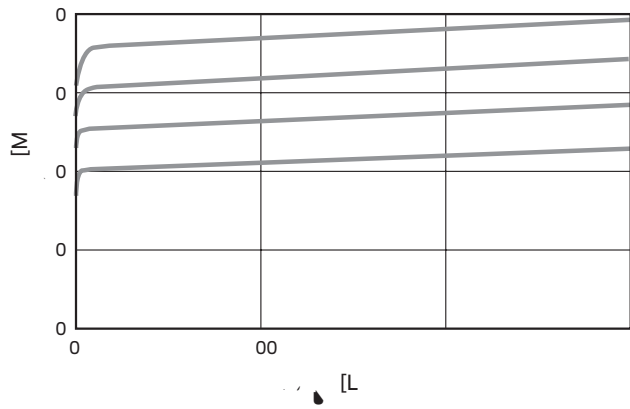

*		

Code				
*				
L    ,    \    /    *				
M    ,    /    \    *3				
H    ,				

Maximum pressure	MPa (psi)	A, B port	40 (5,800)
		Pa, Pb port	3 (435)
Maximum flow at $\Delta P = 1.5$ MPa	L/min (gallon/min)	A, B port	180 (48)

Pressure setting code		100	200	350
Set pressure range	MPa (psi)	3~15 (435~2,180)	10~21 (1,450~3,050)	17~40 (2,470~5,800)
Maximum flow	L/min (gallon/min)	300 (79)		

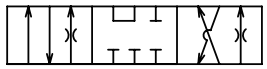
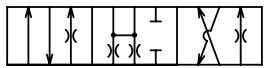
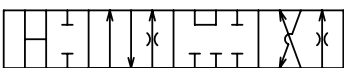
 <b>(BP HPP HP)</b>	
	
	
	

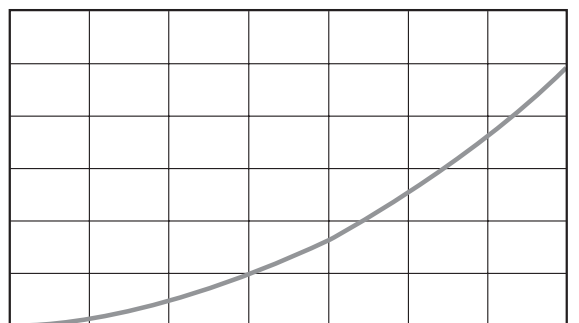



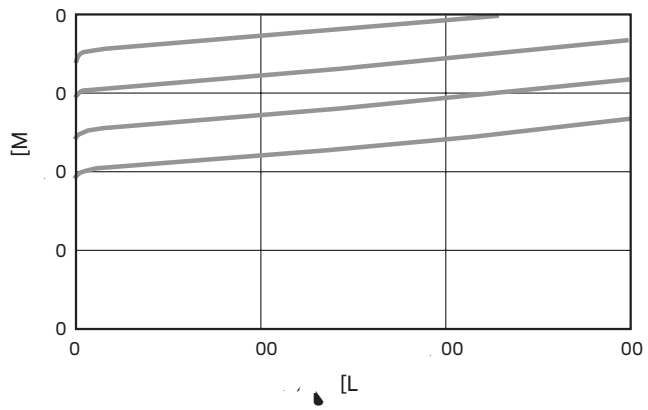

]

---



---



---

	$(-H)$	$(-H)$	$(H)$
H			

0.1 (1 . )	( )
3.0 ~ .0 (3 3 ~ 2 )	( )

0.1 (1 . )	( )
------------	-----

—	( )
---	-----

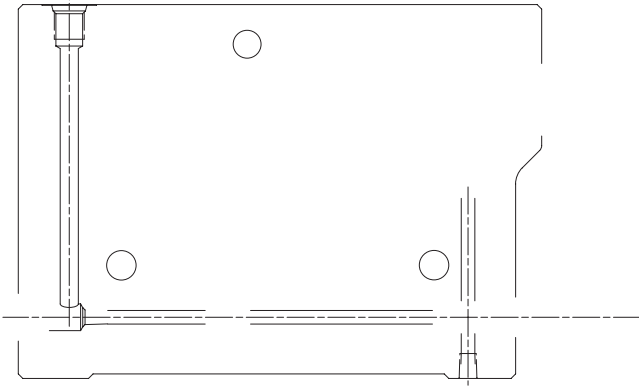

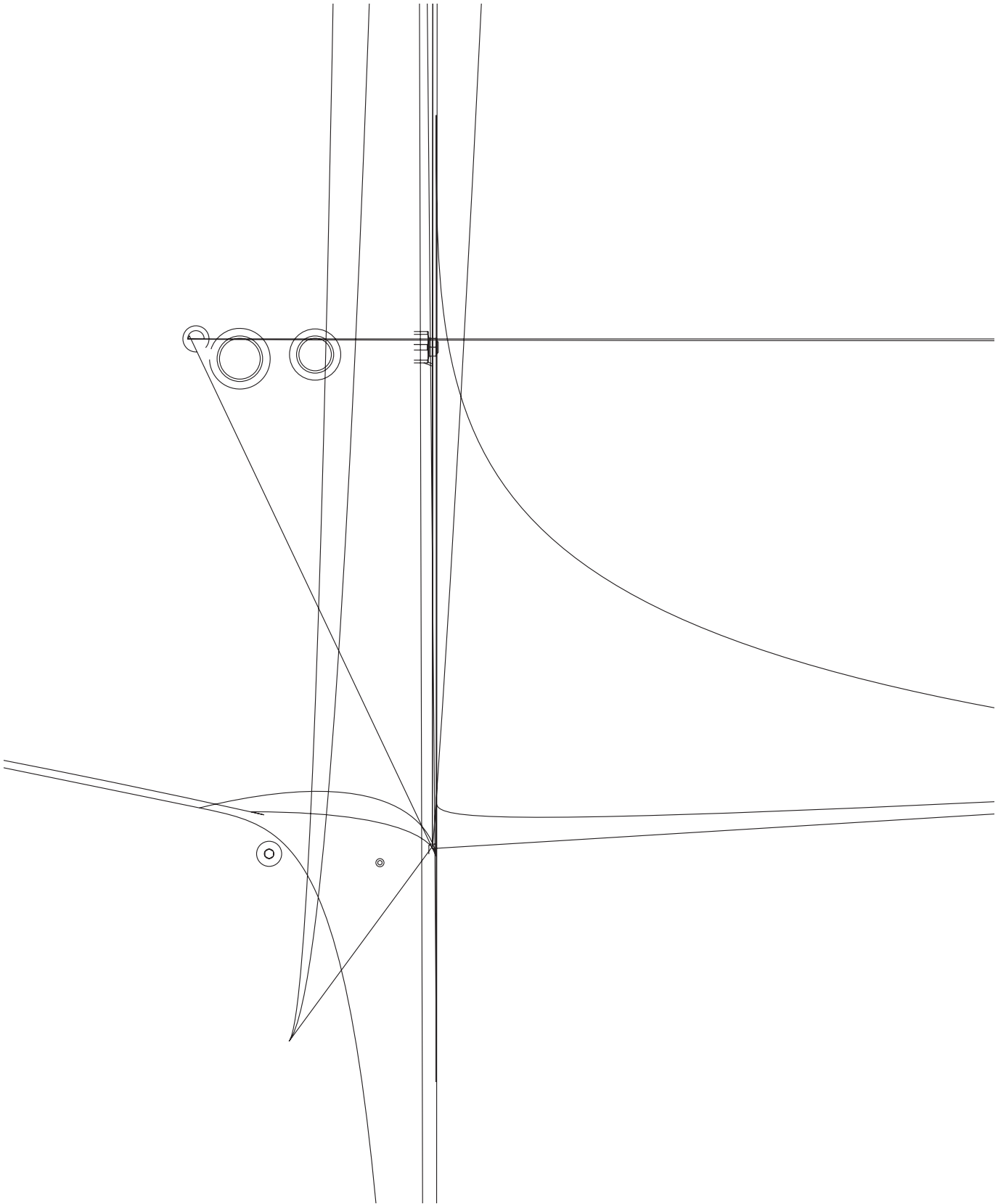

## 6-2 Port size

ØD		- / - ( - )	
# B#	W	- 6- - B J 9 6-	G
		- 6- - B J 9 6-	G
		- 8- - B J 9 6-	G -
D	D	9 6- 8 - B J 9 6-	G
L	L	9 6- 8 - B J 9 6-	G
	( -H )	9 6- 8 - B J 9 6-	G
# #	(H )	9 6- 8 - B J 9 6-	G

Powering your pot

---

---

---

---







